

LED NEON FLEX NDF1212





Features

- Color options: Single color, WN and RGB.
- Design: Superior design with exquisite craftsmanship ensure stable and reliable performance.
- Top bending and easy to shape.
- Warranty: 5 years indoor, 3 years outdoor.
- Customization: multiple spec options, can be customized upon requirements.



Optical & Electrical Parameters

Model No.	Voltage	Beam Angle	CRI	Color	Lm/m	Lm/W	Rated Power (W/m)
NDF1212-Single color	24V DC	115°	>90	2300K	448	38.3	11.5
				2700K	638	55.7	
			/	3000K	691	59.8	
				4100K	734	62.8	
				4800K	744	63.7	
				6000K	710	60.8	
				Red	260	22.3	
				Green	758	65.0	
NDF1212-WN	24V DC	115°	>80	3000K	463	64.3	7.2
				6000K	464	64.9	7.2
				W+N	912	63.7	14.4
NDF1212-RGB	24V DC	115°	/	Red	90	19.2	4.8
				Green	234	47.7	4.8
				Blue	48	10.2	4.8
				RGB	356	25.3	14.4
				Orange	304	26.1	

Basic Parameters

Model No.	LED QTY (pcs/m)	Standard Run	Min. Cuttable Length	Working Temperature	Storage Temperature
NDF1212-Single color	144	15000mm	41.66mm	-20~+60°C	-20~+70°C
NDF1212-WN	240	10000mm	50.0mm		
NDF1212-RGB	120	5000mm	50.0mm		

Note: The given data is typical values. Due to tolerances of the production process and the electrical components, values for light output and electrical power can vary up to 10%.

Profile Drawings

Unit: mm[inch]

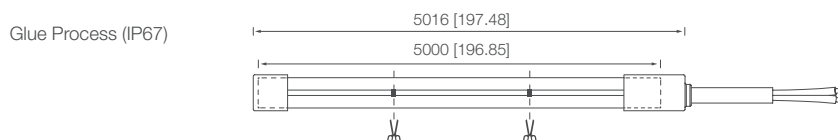

Molding pressed (IP67)

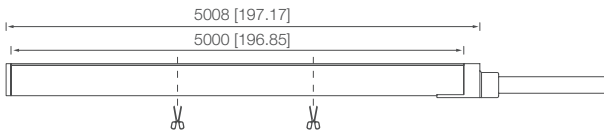

Molding pressed (IP68)

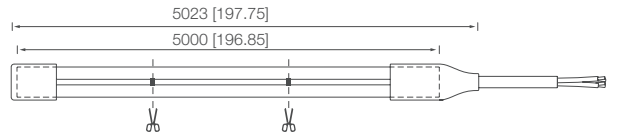

Bend direction

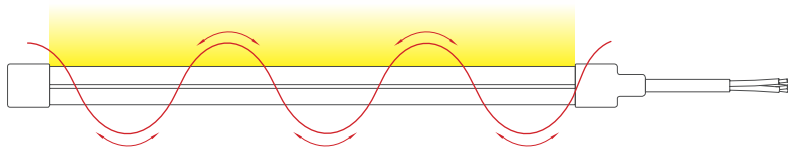

Bending Diameter

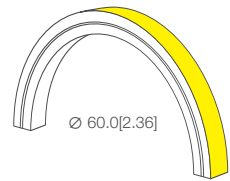

Sectional view

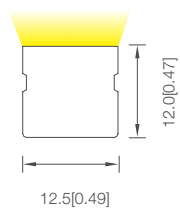

Front cap

Glue Process (IP67)

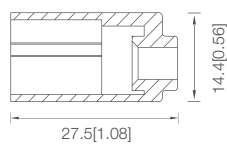

Closing End-cap

Glue Process (IP67)

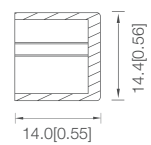

Note: Within 5m, the strip can be customized according to the integer multiple of the Min. cuttable length.

Luminous Intensity Distribution Diagram

Average Illumination

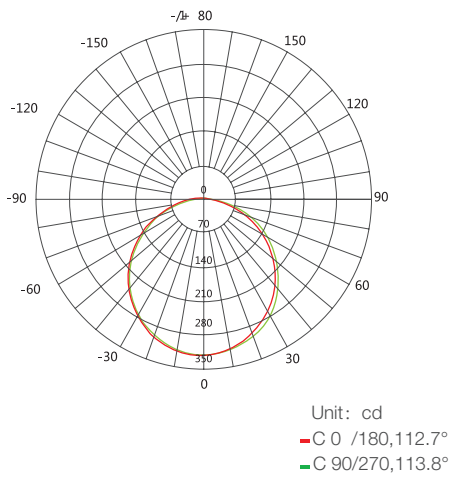

AVERAGE BEAM ANGLE (50%): 113.3°

Flux Out: 393.7lm

Height	Eavg, Emax	Beam Angle: 112.70°	Diameter
0.5m	372.5, 1332lx		150.22cm
1.0m	93.12, 333.1lx		300.45cm
1.5m	41.39, 148.0lx		450.67cm
2.0m	23.28, 83.27lx		600.90cm
2.5m	14.90, 53.29lx		751.12cm
3.0m	10.35, 37.01lx		901.35cm
3.5m	7.601, 27.19lx		1051.57cm
4.0m	5.820, 20.82lx		1201.80cm
4.5m	4.598, 16.45lx		1352.02cm
5.0m	3.725, 13.32lx		1502.25cm

Note: the above two figures are tested with the sample NDF1212-WN at CCT 6000K, for other data, please consult sales rep.

Recommended power supply upon working length

Model No.	NDR1212-Single color		NDF1212-WN		NDF1212-RGB	
Working Length(m)	1	15	1	10	1	5
Measured Current (A)	0.48	7.2	0.6	6	0.6	2.7
Rated Voltage (DC V)	24	24	24	24	24	24
Measured Power(W)	11.52	172.8	14.4	144	14.4	64.8
Recommended Power Supply(W)	24	240	24	200	24	100
Power Supply Mode	Single Feed	Single Feed	Single Feed	Single Feed	Single Feed	Single Feed

Model No.	NDF1212-RGB-R		NDF1212-RGB-G		NDF1212-RGB-B	
Working Length(m)	1	15	1	15	1	15
Measured Current (A)	0.2	2.7	0.2	2.7	0.2	2.7
Rated Voltage (DC V)	24	24	24	24	24	24
Measured Power(W)	4.8	64.8	4.8	64.8	4.8	64.8
Recommended Power Supply(W)	7.2	100	7.2	100	7.2	100
Power Supply Mode	Single Feed	Single Feed	Single Feed	Single Feed	Single Feed	Single Feed

IP Process Technology

Glue Process (IP67)

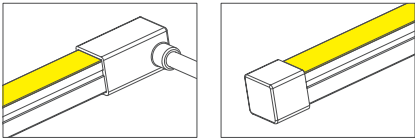

Color
Single color / WN / RGB

Outlet Direction
Straight / Left / Right / Bottom

Molding Pressed (IP67)

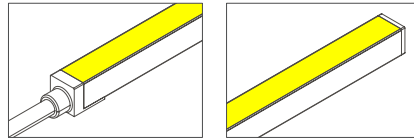

Color
Single color / WN / RGB

Outlet Direction
Straight / Bottom (Single color / WN) Bottom (RGB)

Molding Pressed (IP68)

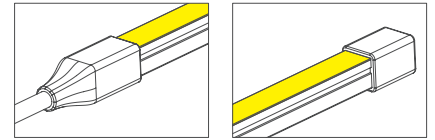

Color
Single color / WN / RGB

Outlet Direction
Straight / Left / Right

- Glue process the end cap after cutting, warranty will be provided upon IP65 rated.
- No warranty will be provided if the injection moulded(IP68) end cap destroyed or reprocessed.
- Corresponding molding equipment and mold needed for self-processing injection moulded end cap, contact the sales for more information.

Product accessories



ASY-NDF1212-N00NNH-EC

Item: Front cap
Dimensions L*W*H: 27.5*14.9*14.4mm
Quantity (5/10/15m): 3/6/9pcs
Free/Optional: Free



ASY-NDF1212-N00NNX-EC

Item: Closing End-cap
Dimensions L*W*H: --
Quantity (5/10/15m): --
Free/Optional: Free



Item: Front cap (Molding Pressed)
Dimensions L*W*H: 44*15.7*15.2mm
Quantity (5/10/15m): 1pcs
Free/Optional: Optional



Item: Closing End-cap (Molding Pressed)
Dimensions L*W*H: 23.0*19.2*20.2mm
Quantity (5/10/15m): 1pcs
Free/Optional: Optional



ASY-NDF1212-N00NNL-EC

Item: Front cap (Left)
 Dimensions L*W*H: 27.5*20.9*14.4mm
 Quantity (5/10/15m): 3/6/9pcs
 Free/Optional: Optional



ASY-NDF1212-N00NNR-EC

Item: Front cap (Right)
 Dimensions L*W*H: 27*20.4*14.4mm
 Quantity (5/10/15m): 3/6/9pcs
 Free/Optional: Optional



ASY-NDF1212-N00NNB-EC

Item: Front cap (Bottom)
 Dimensions L*W*H: 27*20.4*14.9mm
 Quantity (5/10/15m): 3/6/9pcs
 Free/Optional: Optional

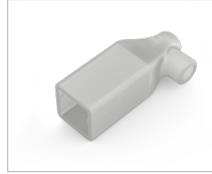

Item: Front cap (Side) (Molding Pressed)
 Dimensions L*W*H: --
 Quantity (5/10/15m): --
 Free/Optional: Optional



ASY-NDF1212-A1NN1000-MT

Item: Aluminum Channel
 Dimensions L*W*H: 1000*14.8*15mm
 Quantity (5/10/15m): 5/10/15pcs
 Free/Optional: Optional



ASY-NDF1212-MNN0500-MT

Item: S-type Track
 Dimensions L*W*H: 500*13.5*13.6mm
 Quantity (5/10/15m): 5/10/15pcs
 Free/Optional: Optional

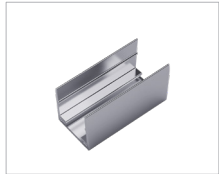

ASY-NDF1212-A3NN0025-MT

Item: 3cm Aluminum track
 Dimensions L*W*H: 35*14.8*15mm
 Quantity (5/10/15m): 15/34/45pcs
 Free/Optional: Optional



ASY-NDF1212-F00NNL-EC

Item: free welding connector (IP54)
 Dimensions L*W*H: 48.5*36.0*15.95mm
 Quantity (5/10/15m): --
 Free/Optional: Optional



ASY-NDF1212-F00NNX-EC

Item: free welding end cap (IP54)
 Dimensions L*W*H: 41.21*16.9*15.85mm
 Quantity (5/10/15m): --
 Free/Optional: Optional



PA3

Item: Screws
 Dimensions L*W*H: PA3*10mm
 Quantity (5/10/15m): 30/60/90pcs
 Free/Optional: Optional



WR-7516

Item: Silicone Glue
 Dimensions: 45g/pc
 Quantity (5/10/15m): 1pc
 Free/Optional: Optional

Accessories diagram

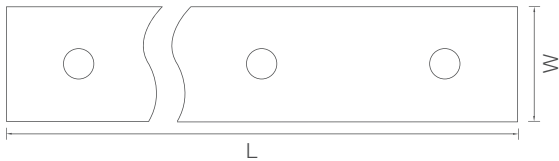

Name	L(mm)	W(mm)	Type
Aluminum channel	1000	14.8	Optional
Aluminum channel X	X	--	Customized

Note:

1. All accessories can be added according to customer requirements;
2. If customers want to process molded caps by themselves, they should use the corresponding molds and molding equipment;
3. If customers reprocess the molded cap themselves, the resulting quality risks are not covered by the warranty;

Products and Tools

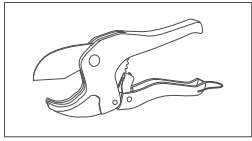

Cutter

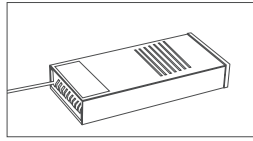

LED power supply

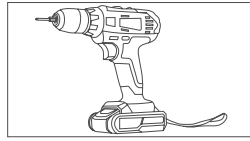

Electric drill

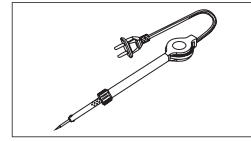

Electric iron

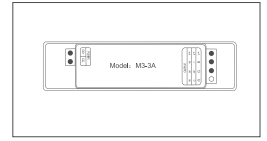

Controller (If needed)

Installation

Front cap installation

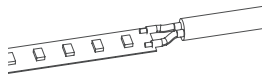

Weld the wire to the PCB board.

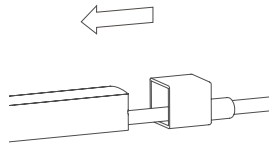

Apply waterproof glue to the front cap, then push the cap into the strip.

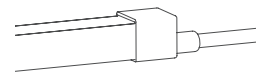

Wipe off the excess glue and wait for the glue to solidify.

Closing-end cap installation

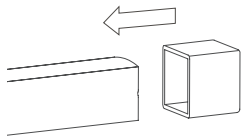

Apply waterproof glue to the end cap, then push the cap into the strip.

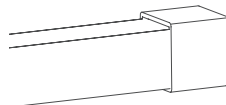

Wipe off the excess glue and wait for the glue to solidify.

Aluminum channel installation

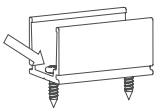

Fix the aluminum channel with screws

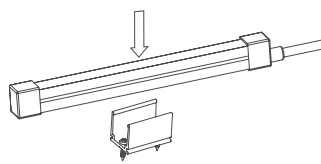

Press the strip into the channel

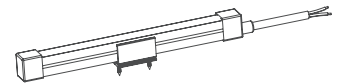

Finished

Notes:

- At the welding place, please pay attention to the positive and negative poles of the wire and the strip;
- Each connection must use 10g silica gel for waterproof and insulating treatment;
- The screws must be vertical to the mounting surface and be fastened, as shown in the figure on the right;
- Please choose suitable operation steps according to the actual needs;
- During mounting, please pay attention to the min bending diameter, and best to use original factory accessories;
- More information, please feel free to consult us;



Controller wiring diagram

NDF1212-WN

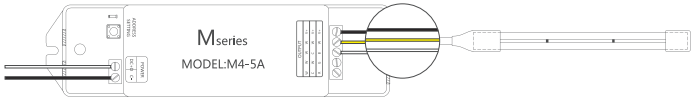

NDF1212-RGB

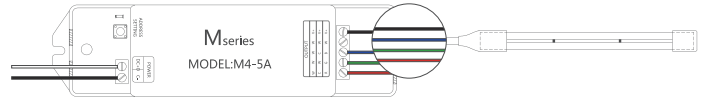

Notes:

1. The case uses M4-5A CCT controller;
2. NDF1212-WN supports remote M2 control; NDF1212-RGB supports remote M4 control;
3. The remote control distance is 30 meters;
4. M4-5A WN maximum driving power 120W(12V)/240W(24V); M4-5A RGB maximum drive power 180W(12V)/360W(24V);
5. M4-5A controller working voltage: DC12-24V

Packaging Information

Packaging method - 5m standard run



Roll the product to a reel

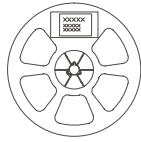

Label the reel;

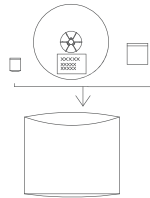

Put reel, accessory bag and desiccant together into a foil bag;

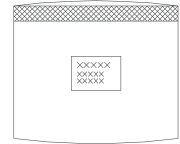

Label the foil bag;

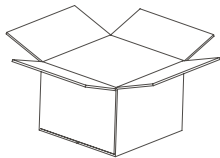

Put the foil bags into a carton box;

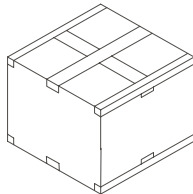

Seal the carton box;

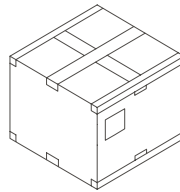

Label the carton box;

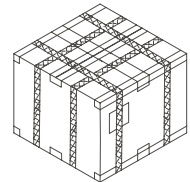

Use packing belt to pack. Add edge protectors if necessary

Packaging method - 10/15m standard run

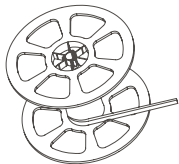

Roll the product to a reel

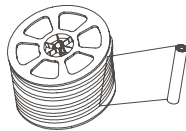

Wrap it with PE film

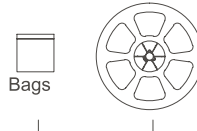

Put the reel and accessories bag on the work table

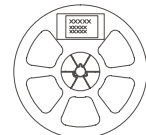

Label the reel;

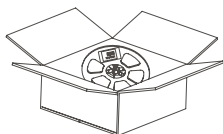

Put the prepared products into a carton box;

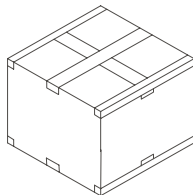

Seal the carton box;

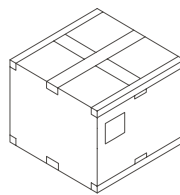

Label the carton box;

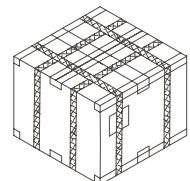

Use packing belt to pack. Add edge protectors if necessary

Packaging information

Model No.	Product Size L*W (mm)	Carton Size (mm)	Meter/Reel	Reel/Carton	Gross Weight (kg)
NDF1212-Single color	15000*12.5*12	390*390*325	15	3	11.15 (1± 10%)
NDF1212-WN	10000*12.5*12	390*390*325	10	3	8.45 (1± 10%)
NDF1212-RGB	5000*12.5*12	390*390*325	5	15	17.95 (1± 10%)

- One piece(5/10/15m) per reel, and the reel is packed in a bag, and finally put in a carton.
- For other customized length packaging, please ask our sales rep.
- The above-mentioned packaging quantity and weight are only for the illustrated packaging method. For other packaging methods, the packaging quantity and weight will be different. The actual weight is subject to the actual product.

Reliability test

Project	Reference standards	Category	Test conditions	Outcome
Environmental test	Blueview standard	Temperature cycling test	Th = 60°C/4h, Ta =20°C/1H, TL=- 40°C/4h,continuous cycle lighting	Pass
		High temperature resistance test	Simulated TH=60 °C, continuous power on	
		Room temperature bending test	Bending diameter 60mm, continuous power on under room temperature	
		PTC test	Test temperature -40°C to 60°C, cycle once every 2h (temperature holding time 15min, heating and cooling time 45min)	
Mechanical strength testing	Blueview standard	Tensile test	Fix both ends of the sample on the upper and lower clamps of the tensile machine and record the tensile value of the product when the light is off.	Pass
		Twisting test	Light on the sample, forward and reverse rotation 360° one time each, a total of 10 times.	
		Lifting strength test	Fix the sample on the aluminum clip or channel, place the strip side down for 1 hour, and observe whether the light strip falls off.	

Warning Mark

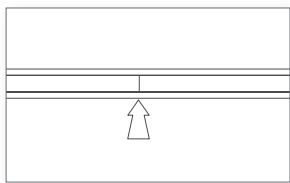

Cuttable identifier

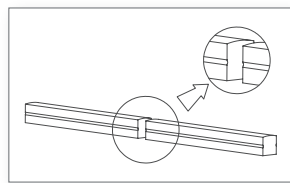

Neat and smooth cut

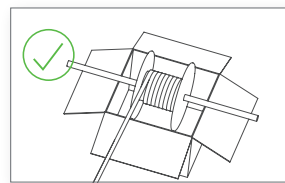

Insert a stick on the reel and place it on the packing box, and rotate the reel to get the product.

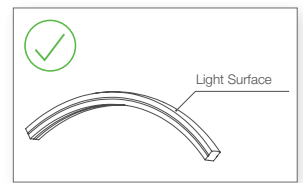

use in convex direction

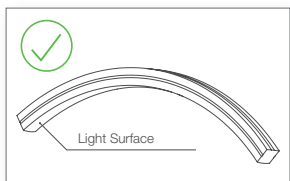

Use in concave direction

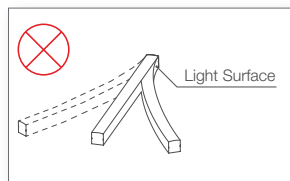

Side bending

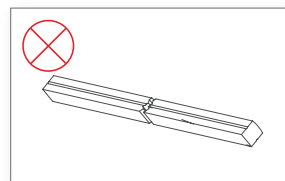

Do not make irregular cuts.

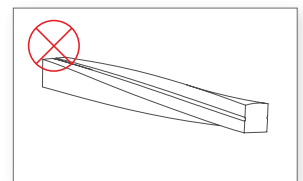

Do not use in distortions

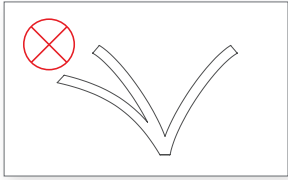

Do not bend many times, for it can endanger electronic lines.

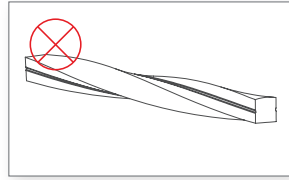

Do not use on wringing (twist)

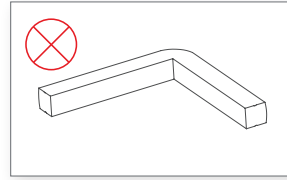

Do not bend at right angles

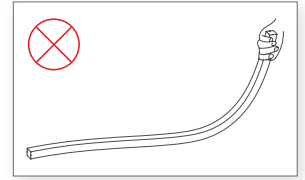

Do not throw or pull when taking products

Note:

The cutting mark is on the PCB, and the cutting position can be identified in the product cutting line window or the laser mark on the product surface; After unpacking, use warning signs during handling and installation, and rigorous operation can bring a pleasant experience;

Warning

- Do not disassemble or retrofit the light. Do not touch the surface of the light with a sharp object.
- Do not do live-line working during installation, especially for high voltage product.
- Do not use any organic chemical solvents.
- Use neutral glass adhesive to fix this product and it needs to be dried 4 hours in the open environment after operation.
- Treat the ends and the circuit connection points that are not connected to the main line with insulation, waterproof, and anti-corrosion in the installation.
- Use 18AWG (0.75mm² cross-sectional area) or thicker core wire to avoid adverse consequences caused by overheating, if the power cable need to lengthen.
- Make sure the input voltage meets the requirements and lines are connected correctly before lighting on
- This product is for signage, and do not use as general lighting.
- Series connection within the max run.
- The length of the power cable between the power supply and the led strip should not exceed 2 meters. Otherwise, large circuit loss will lead to inconsistent brightness.
- Installation, maintenance and repair should be operated by a qualified technician.

Attentions before installation

- Before installation, check that the product parameters are consistent with the requirements (Seeing product specifications or product labels)
- Load voltage, current, power and power supply should be matched with the product.
- Follow the instructions of wiring diagram (first connect the load and then the power supply) to avoid short circuit
- Make sure the correct connection of positive and negative poles between products and power supply. Otherwise, the light will not be on.
- Make sure the power cord firmly screwed into the terminal and it should not be pulled out by hands.
- The terminal should have waterproof and anti-corrosive treatment.

Statements and Recycling

Packaging information

- Repair should be operated by a qualified technician or supplier, if the external circuit or main line of this product is damaged.
- The parameters given in this manual are typical values and for reference only
- All illustrations and drawings in this manual are for reference.
- This product is subject to change without notice.

Recycling

- LED lighting products belongs to electronic products, please do recycling treatment according to the relevant WEEE directives.

BLUEVIEW ELEC-OPTIC TECH CO.,LTD

☐ Tel: +86-28-8148 0011
☐ Fax: +86-28-8148 1258

☐ Web.: Web.: www.blueviewled.com
☐ Email: sales@blueviewled.com

☐ Add.: No. 1000, Section 2, Konggang 2nd Road, Shuangliu, Chengdu 610207, Sichuan, CHINA